

2 BL

街廓原子一覽表用紙

( 2 BL )

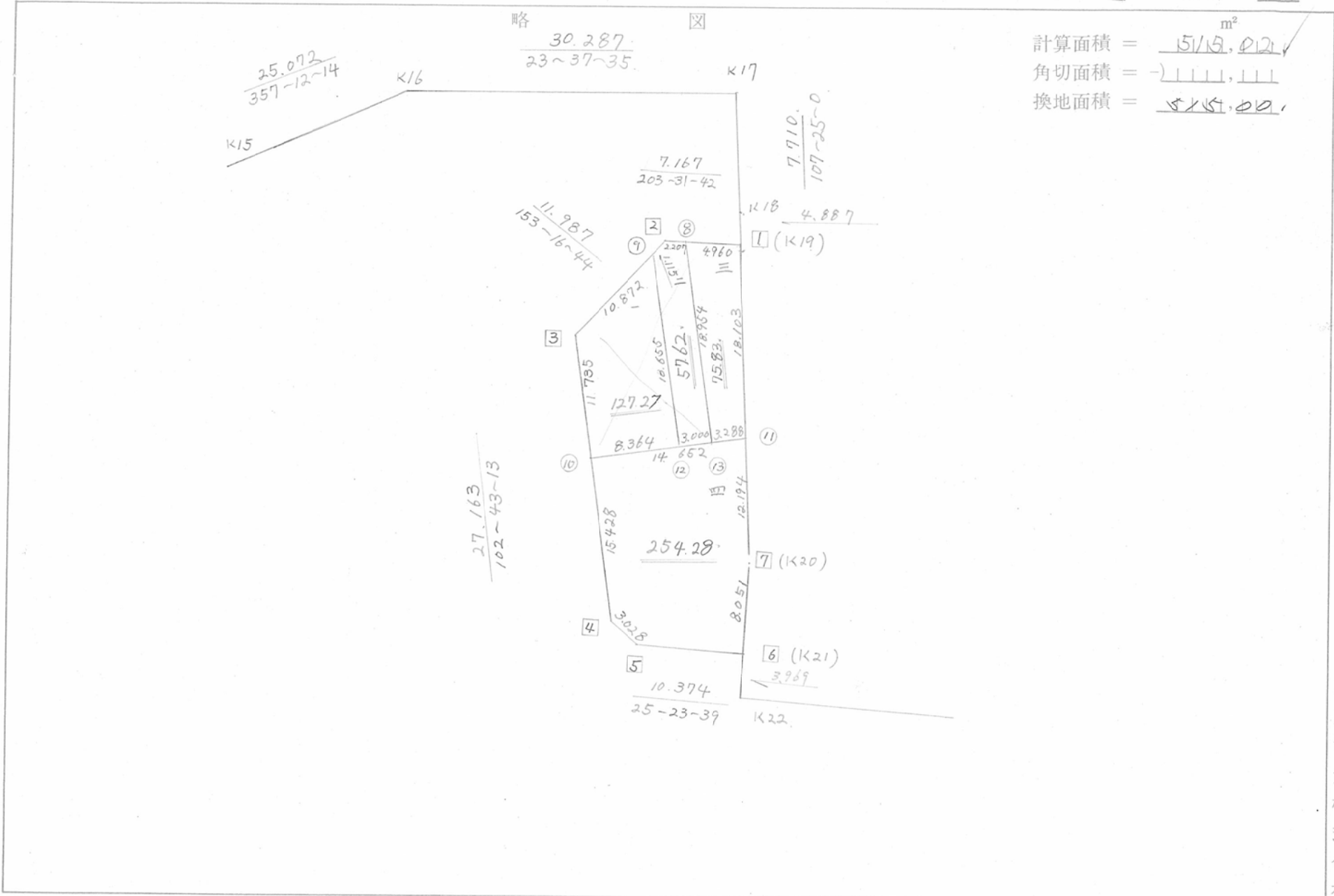

計算面積 =  $\frac{5119.02}{m^2}$   
 角切面積 =  $\frac{1111.111}{m^2}$   
 換地面積 =  $\frac{5119.02}{m^2}$

境界点最終番号 (B)

不二測量株式会社

\*\*\*\*\* ベンセキ ケイサン (ハ) イオウキヨボウ \*\*\*\*\*

レイ NO .. 2BL

NO	AZIMUTH	LENGTH	DX	DY	X	Y	DMD	2A
2B	1 (K19)				-144270.065	-70470.758		
2B	2 203 31 42	7.167	-6.571	-2.861	-144276.636	-70473.619	-31.686	208.208706
2B	3 153 16 44	11.987	-10.707	5.390	-144287.343	-70468.229	-29.157	312.183999
2B	4 102 43 13	27.163	-5.981	26.496	-144293.324	-70441.733	2.729	-16.322149
2B	5 64 5 42	3.028	1.323	2.724	-144292.001	-70439.009	31.949	42.268527
2B	6 (K21) 25 23 39	10.374	9.372	4.449	-144282.629	-70434.560	39.122	366.651384
2B	7 (K20) 293 41 1	8.051	3.234	-7.373	-144279.395	-70441.933	36.198	117.064332
2B	1 287 56 8	30.297	9.330	-28.825	-144270.065	-70470.758	0.000	0.000000
TOTAL..		98.067					TOTAL ..	1030.054799
							ベンセキ ..	515.0273995

\*\*\* マンセキ ケイサン (ハ イオウキヨボウ) \*\*\*

レイ NO .. 2BL-1

NO	AZIMUTH	LENGTH	DX	DY	X	Y	DMD	2A
2B 9					-144277.632	-70473.118		
2B 3	153 16 <sup>44</sup> / <sub>37</sub>	10.872 /	-9.711	4.889	-144287.343	-70468.229	-13.301	129.166011
2B 10	102 43 <sup>13</sup> / <sub>14</sub>	11.735 /	-2.584	11.447	-144289.927	-70456.782	3.035	-7.842440
2B 12	12 48 <sup>28</sup> / <sub>24</sub>	8.364 /	8.156	1.854	-144281.771	-70454.928	16.336	133.236416
2B 9	282 49 8	18.655 /	4.139	-18.190	-144277.632	-70473.118	0.000	0.000000
TOTAL..		49.626					TOTAL ..	254.559987
							合計 ..	127.2799935

\*\*\*\* メンセキ ケイサン (ハイオウキヨボウ) \*\*\*\*

レイ NO .. 2BL-2

NO	AZIMUTH	LENGTH	DX	DY	X	Y	DMD	2A
2B 8					-144274.612	-70472.738		
2B 2	203 31 <sup>42</sup> <del>21</del>	2.207	-2.024	-0.881	-144276.636	-70473.619	-19.356	39.176544
2B 9	153 <sup>16 44</sup> <del>17 49</del>	1.115 <sub>v</sub>	-0.996	0.501	-144277.632	-70473.118	-19.736	19.657056
2B 12	102 <sup>43 13</sup> <del>49 8</del>	18.655 <sub>v</sub>	-4.139	18.190	-144281.771	-70454.928	-1.045	4.325255
2B 13	12 48 <sup>28</sup> <del>21</del>	3.000	2.925	0.665	-144278.846	-70454.263	17.810	52.094250
2B 8	282 54 28	18.954	4.234	-18.475	-144274.612	-70472.738	0.000	0.000000
TOTAL..		43.931					TOTAL ..	115.253105
							メンセキ ..	57.6265525

\*\*\*\*\* 本セキ ケイサン (ハイオウキヨボウ) \*\*\*\*\*

セリ NO .. 2BL-3

NO	AZIMUTH	LENGTH	DX	DY	X	Y	DMD	2A
2B 1					-144270.065	-70470.758		
2B 8	203 31 <sup>42</sup> 54	4.9 <sup>60</sup> <del>59</del>	-4.547	-1.980	-144274.612	-70472.738	-19.204	87.320588
2B 13	102 54 28	18.954	-4.234	18.475	-144278.846	-70454.263	-2.709	11.469906
2B 11	12 48 <sup>26</sup> 54	3.288	3.206	0.729	-144275.640	-70453.534	16.495	52.882970
2B 1	287 56 8	18.1 <sup>03</sup> <del>04</del>	5.575	-17.224	-144270.065	-70470.758	0.000	0.000000
TOTAL..		45.305					TOTAL ..	151.673464
							本セキ ..	75.8367320

\*\*\* メンセキ ケイサン (ハイオウキヨボウ) \*\*\*

レイ NO .. 2BL-4

NO	AZIMUTH	LENGTH	DX	DY	X	Y	DMD	2A
2B 4					-144293.324	-70441.733		
2B 5	64 5 42 .	3.028 ,	1.323	2.724	-144292.001	-70439.009	17.773	23.513679
2B 6	25 23 39 .	10.374 ,	9.372	4.449	-144282.629	-70434.560	24.946	233.793912
2B 7	293 41 1 ,	8.051 ,	3.234	-7.373	-144279.395	-70441.933	22.022	71.219148
2B 11	287 56 8 .	12.194 ,	3.755	-11.601	-144275.640	-70453.534	3.048	11.445240
2B 10	192 48 28 .	14.652 ,	-14.287	-3.248	-144289.927	-70456.782	-11.801	168.600887
2B 4	102 43 13	15.428 ,	-3.397	15.049	-144293.324	-70441.733	0.000	0.000000
TOTAL..		63.727					TOTAL ..	508.572866
							メセキ ..	254.2864330