

公 図 写 S=1:500

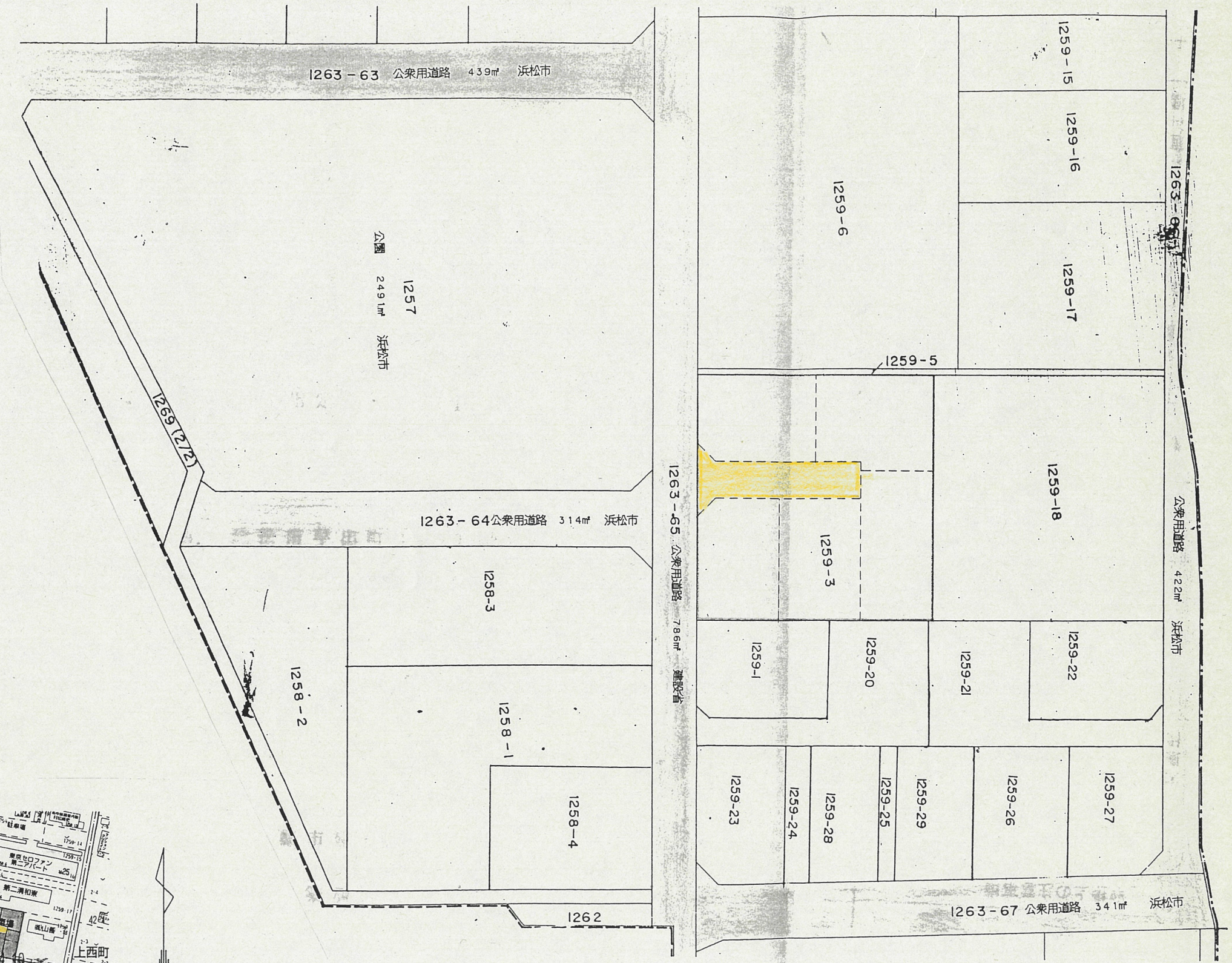

付近見取図

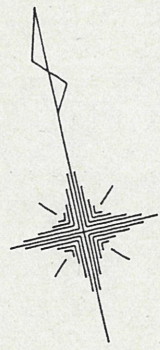
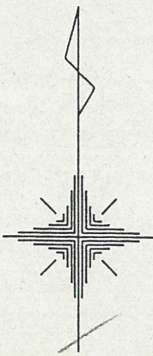
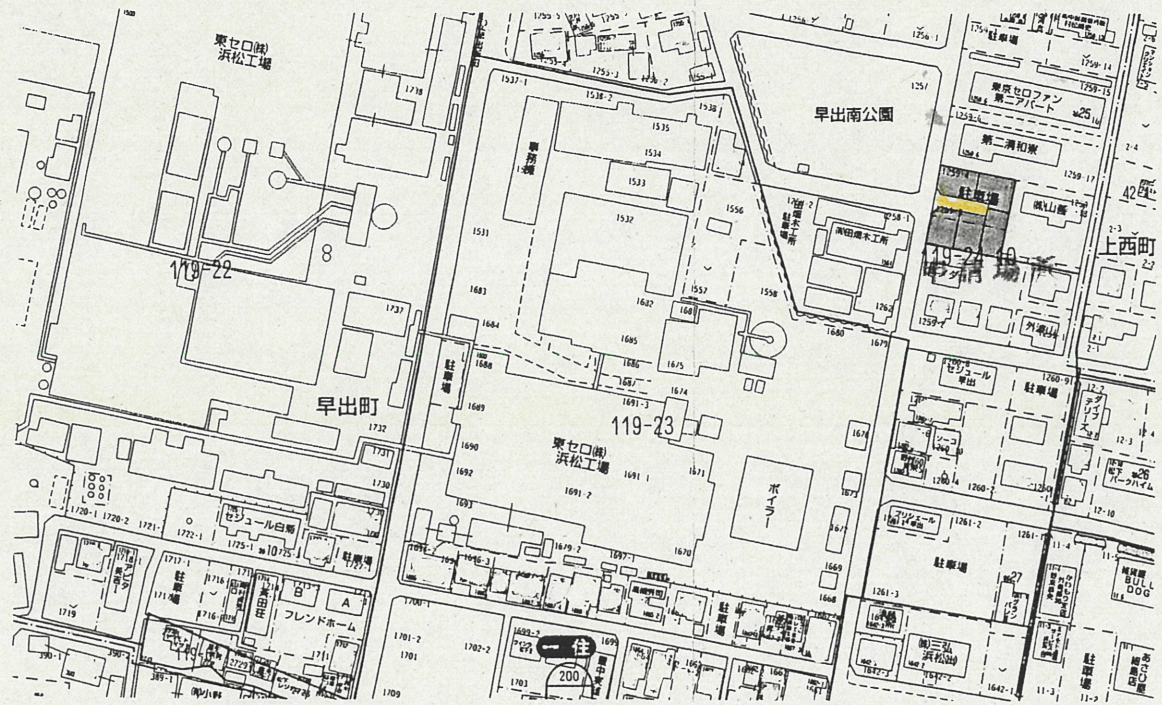

道路位置指定図	指定番号	12-10
早出町地内	指定年月日	H12.11.1

道路位置指定図	指定番号	12-10
早出町地内	指定年月日	H12.11.1

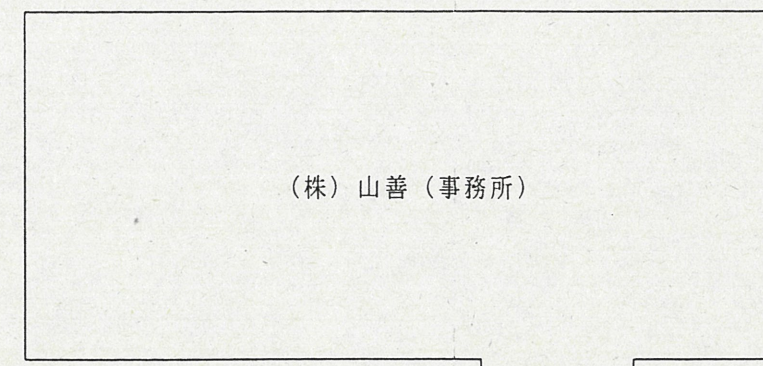
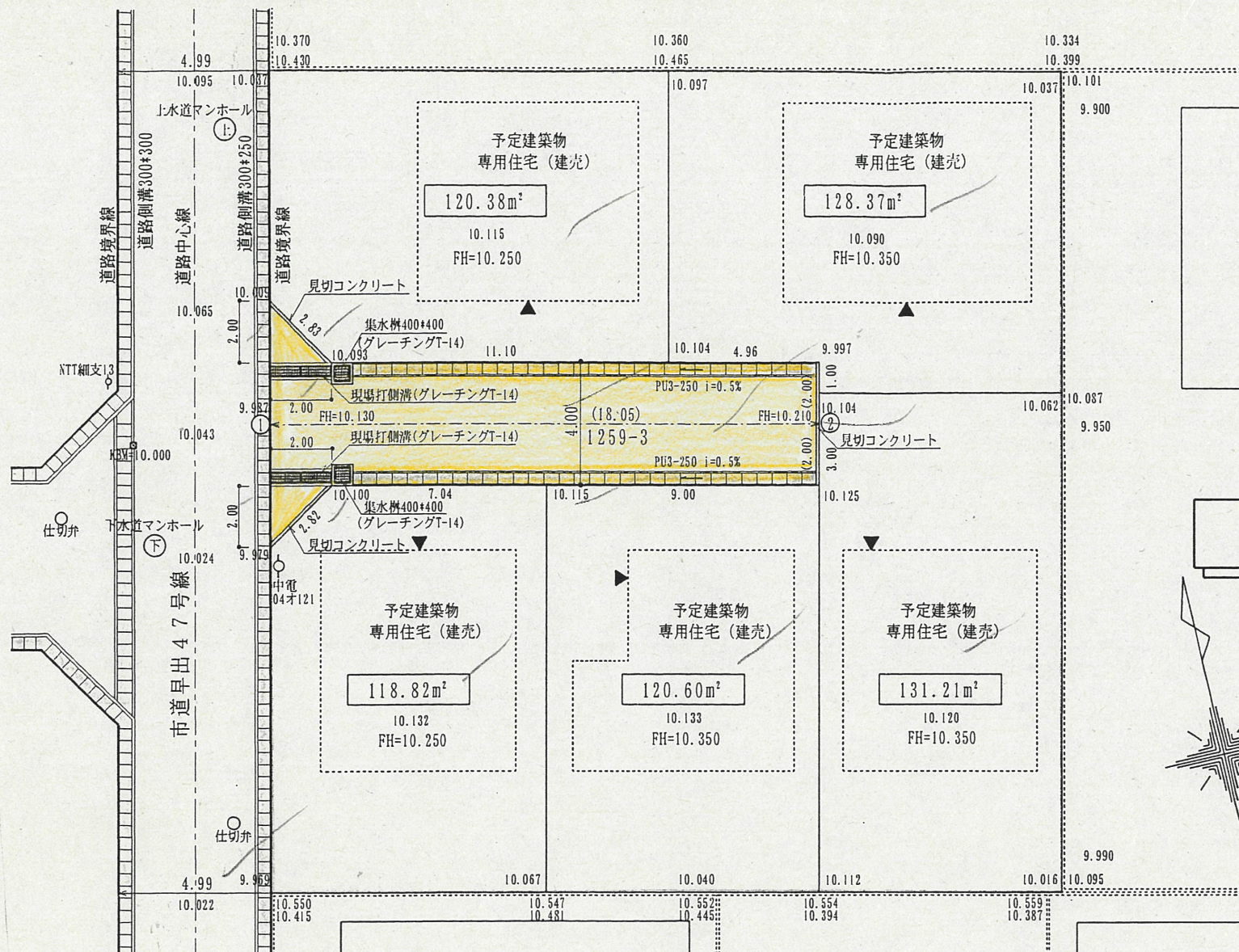

実測図 S=1:200

総開発面積 695.58m²
 指定道路面積 76.20m²

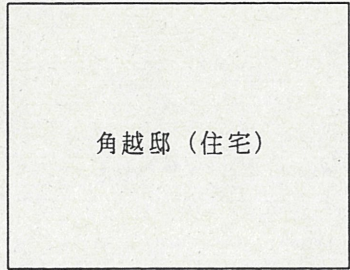
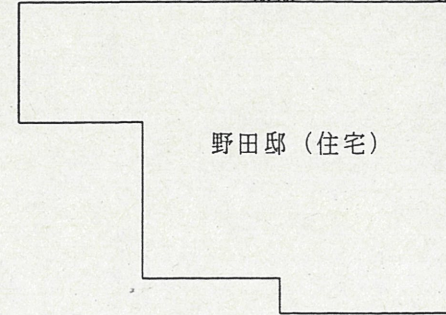
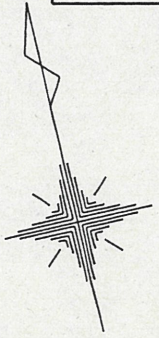

道路断面図

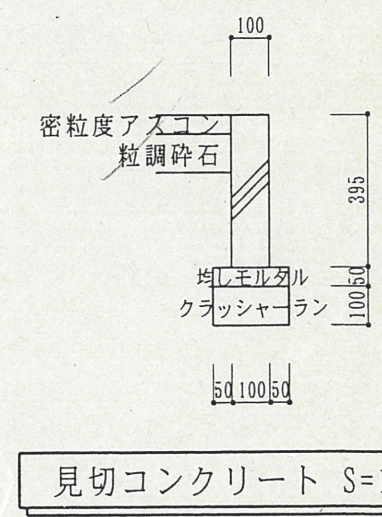
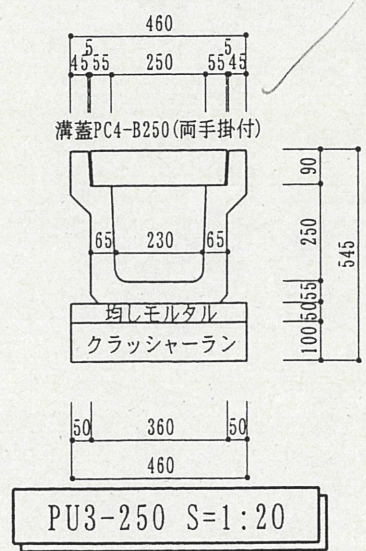
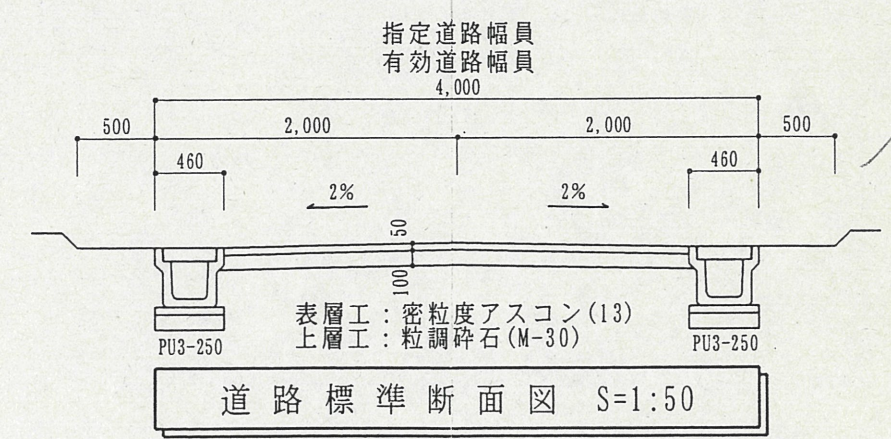

PU3-250 S=1:20

見切コンクリート S=1:20