

附近見取図

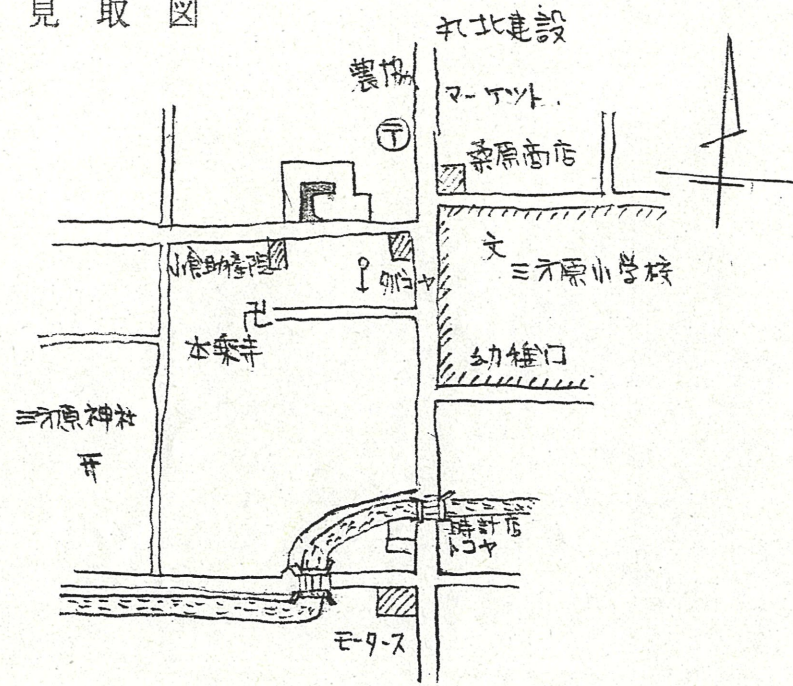

断面図

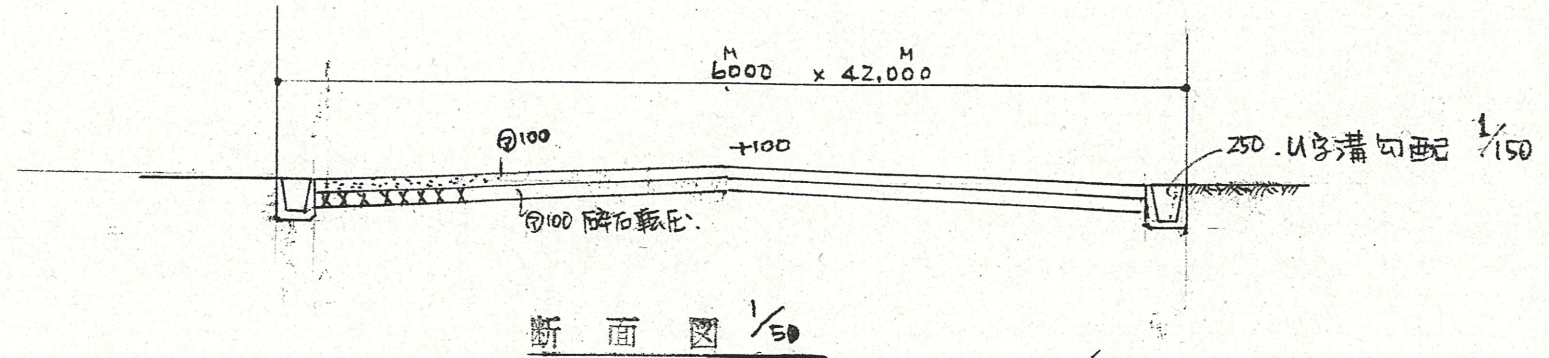

道路位置指定図	指定番号	46-126
三方原町 地内	指定年月日	S47. 5.29

地籍図 (実測図及び公図写)

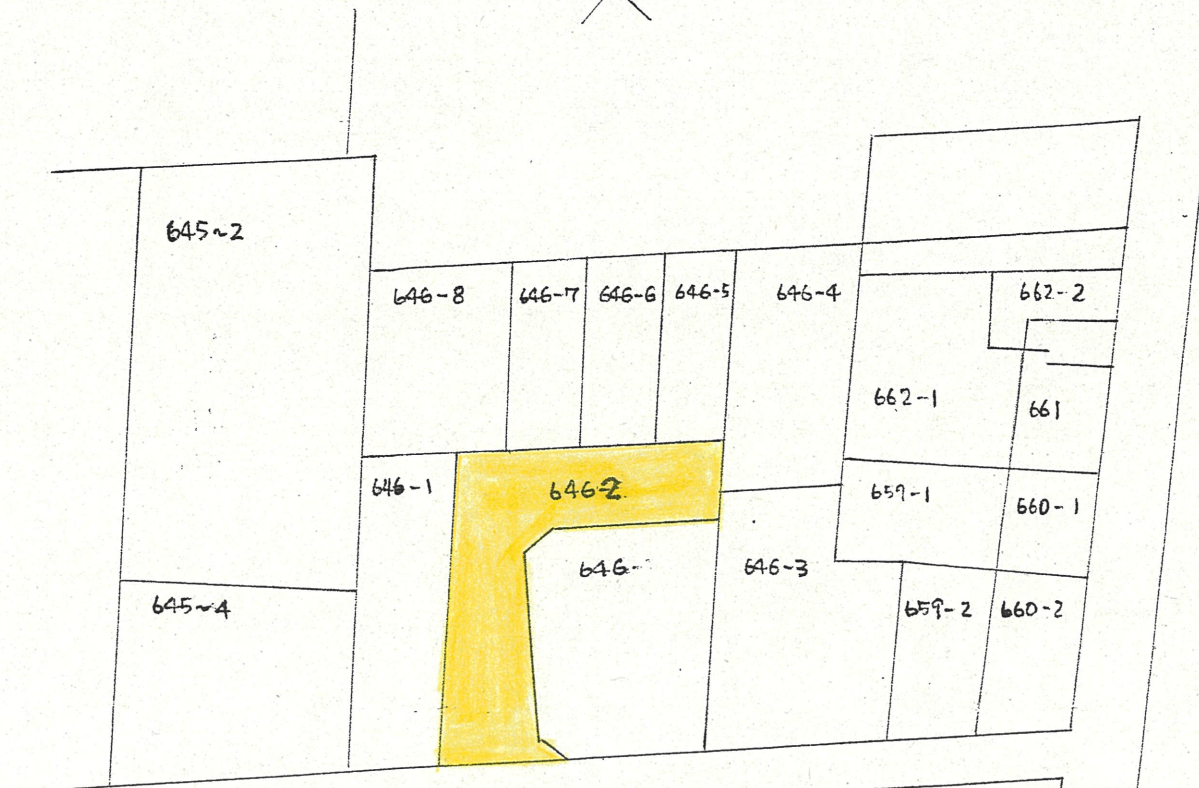
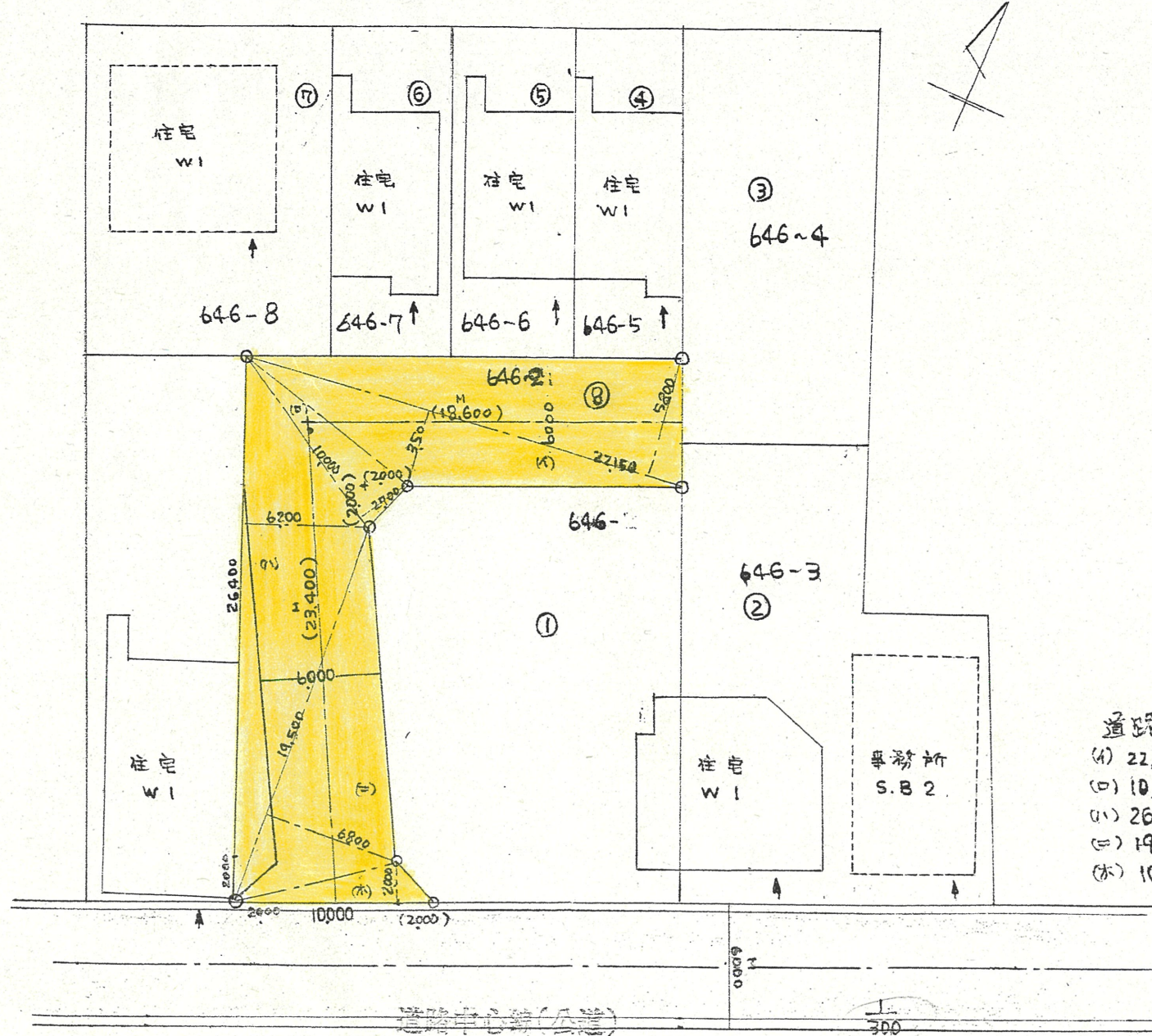

道路面積

(a) $22,150 \times (5,800 + 7,500) = 205,995 \text{ M}^2$
 (b) $10,000 \times 2,700 = 27,000 \text{ M}^2$
 (c) $26,400 \times 6,200 = 163,680 \text{ M}^2$
 (d) $19,500 \times 6,800 = 132,600 \text{ M}^2$
 (e) $10,000 \times 2,000 = 20,000 \text{ M}^2$

計 $549,275 \text{ M}^2$
 $\frac{1}{2}$ $274,637 \text{ M}^2$
 (延 4200M)

公図写 $\frac{1}{600}$