

1 附近見取図

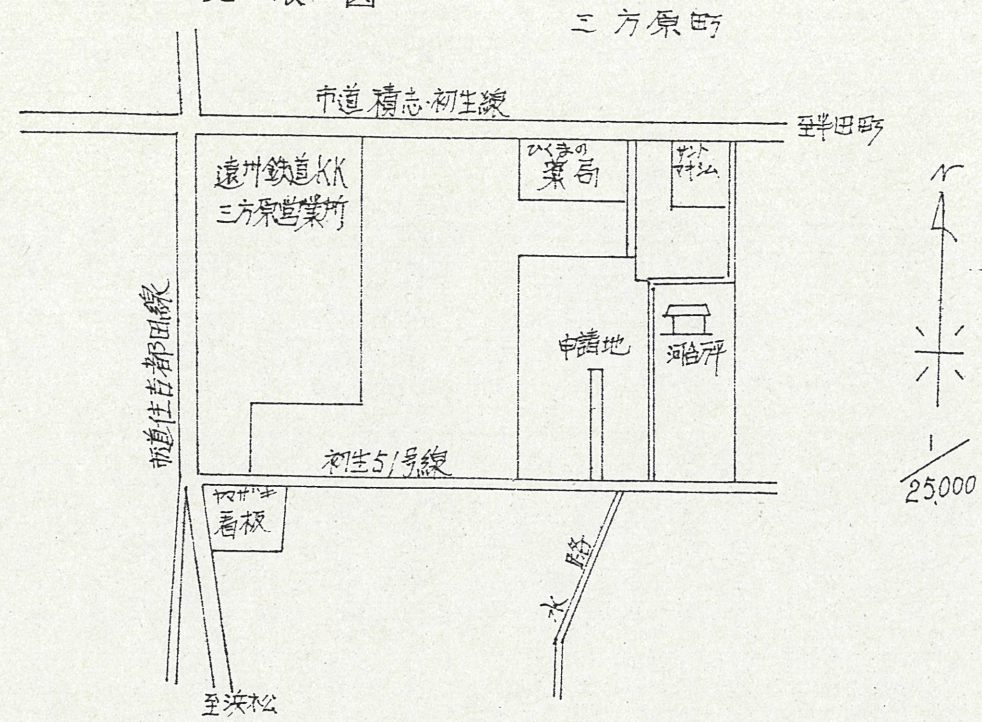

2 断面図

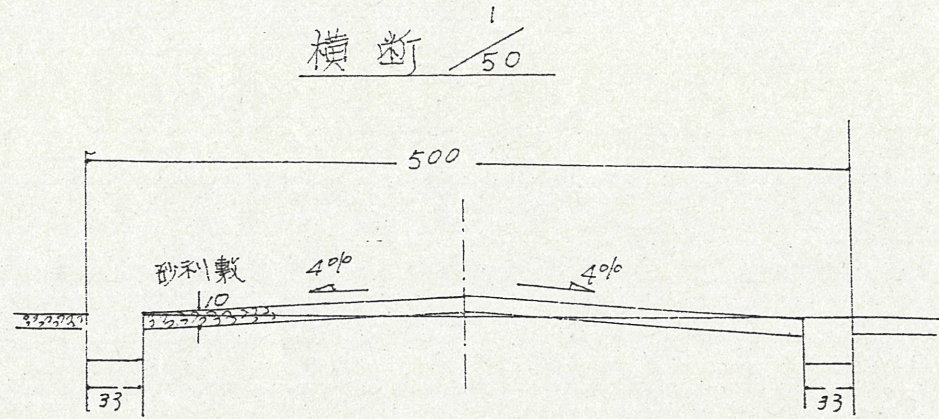

道路位置指定図	指定番号	57-13
初生町 地内	指定年月日	S58. 5.26

実測図

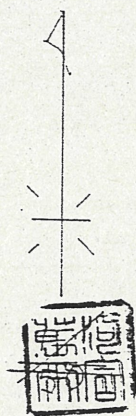
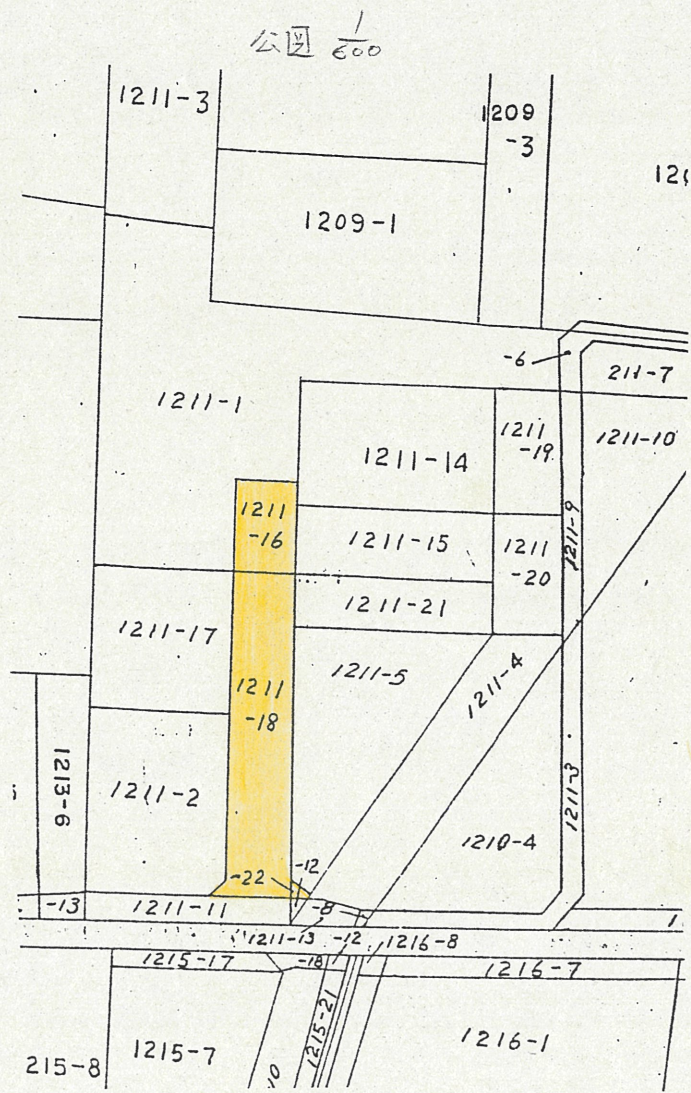

1/300

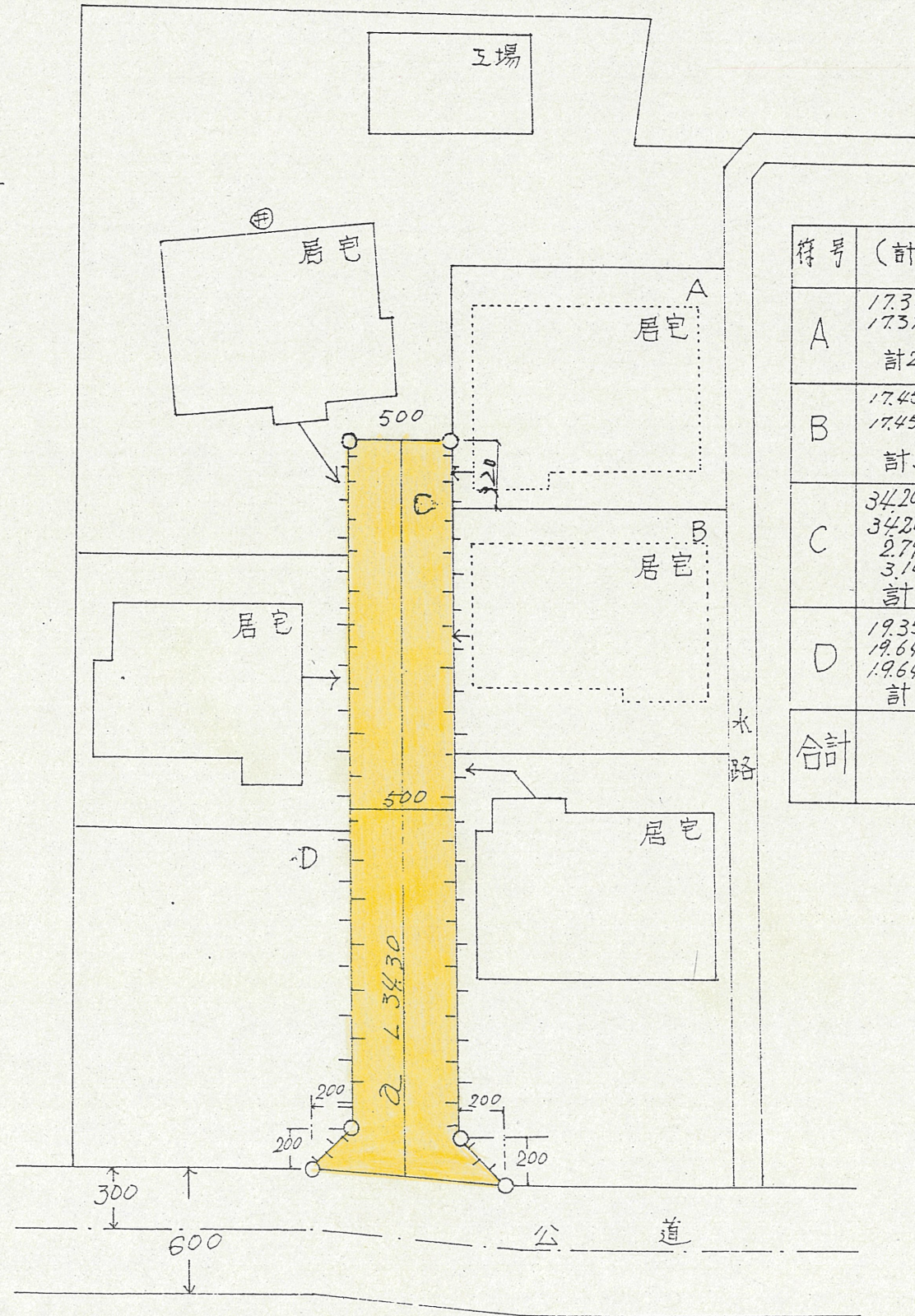

符号	(計算式)	地積
A	$17.3 \times 8.55 = 147.915$ $17.3 \times 8.60 = 148.780$ 計 $296.695 \times \frac{1}{2} = 148.34$	m^2
B	$17.45 \times 8.65 = 150.942$ $17.45 \times 8.60 = 150.070$ 計 $301.012 \times \frac{1}{2} = 150.50$	m^2
C	$34.20 \times 4.96 = 169.632$ $34.20 \times 5.00 = 171.000$ $2.79 \times 1.45 = 4.045$ $3.10 \times 1.25 = 3.875$ 計 $348.552 \times \frac{1}{2} = 174.27$	m^2
D	$19.35 \times 9.53 = 184.405$ $19.64 \times 2.74 = 53.813$ $19.64 \times 9.28 = 182.259$ 計 $420.478 \times \frac{1}{2} = 210.23$	m^2
合計		683.34